

## HALLS

### TECHNICAL SPECIFICATIONS

**BEC** has 6 halls without columns on either side of a main street which runs from north to south and provides 150,000 m<sup>2</sup> of exhibition area

Halls 1, 2 and 3 have separating curtains which divide the 15,000 m<sup>2</sup> of each hall into three 5,000 m<sup>2</sup> spaces.



### ROOM CAPACITIES

	Surface area (m <sup>2</sup> gross)	Height (m)	Dimensions (LxW) (m) Net/	Capacity			
				Banquet	Cocktail	School	Theatre
Central Atrium	16,729	7	550 x 25				
Bizkaia Arena	26,000	Max 18 Min 12					13,448
Halls 1, 2, 3 and 6	15,718	Max 18 Min 12	125 x 125	4,000	10,000	5,000	7,000
Hall 5	20,599	Max 18 Min 12	130 x 160	6,000	12,000	7,000	10,000

### DESCRIPTION ELEMENTS

#### **CEILING:**

The ceiling of the halls is covered with a spatial grid with a hanging load capacity of 270 kg/ball. The distance between balls is 3.65 m  
 Ceiling beams with a width of more than 7m are excluded from this grid.

#### **FLOORS:**

The floors of the halls have a maximum overload of 4,000 kg/m<sup>2</sup>  
 All halls have power conduits (with 63 A and 32 A connections), voice and data, water and draining every 6 m.

#### **ACCESS:**

Each hall has 8 access gates (opposing 4 to 4) 7 m wide and 5 m high to provide access for vehicle loading, providing ample room to manoeuvre from any point inside the hall, and thus faster assembly and dismantling.

BEC has a 1 km long internal perimeter road with a single 14 m wide access point (South Gate).

## EQUIPMENT:

All the halls have general public address systems with fixed and wireless microphones. This public address system can be operated for each individual hall or for all halls from any control centre located on floor number 2 of the hall.

Both the halls and the perimeter road have CCTV in the BEC Control Centre with qualified staff present 24 hours per day.

All access to the hall, as well as the general lighting and air conditioning, is controlled from the Control Centre, allowing a great deal of flexibility during any event.

## LAYOUT MODELS

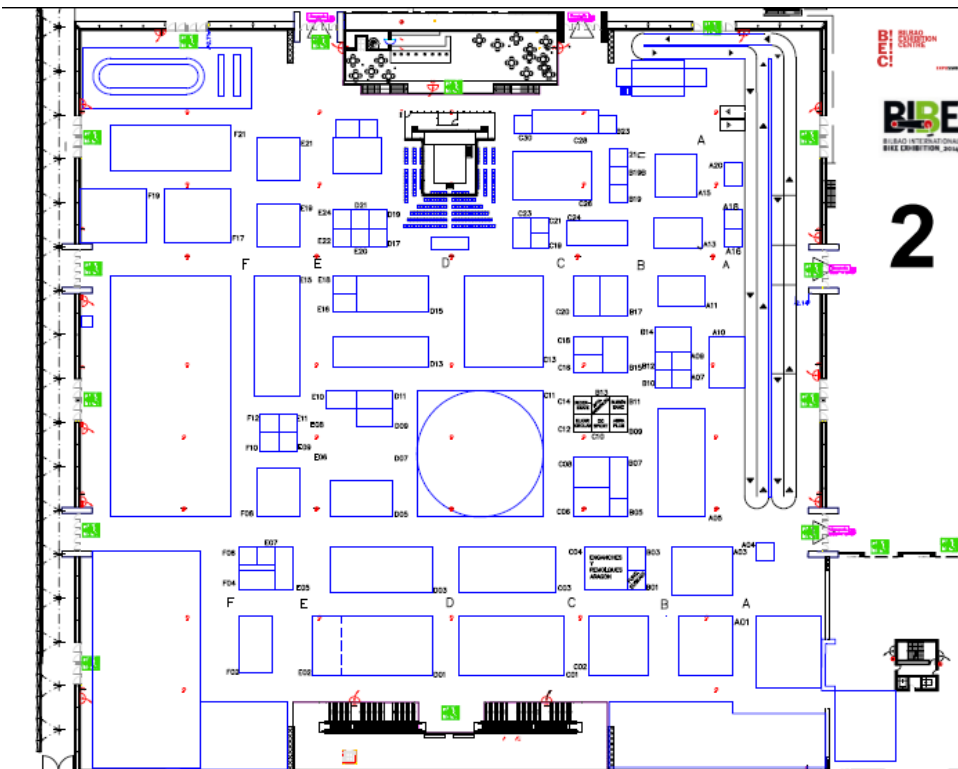

Show spread over 15,000 m2

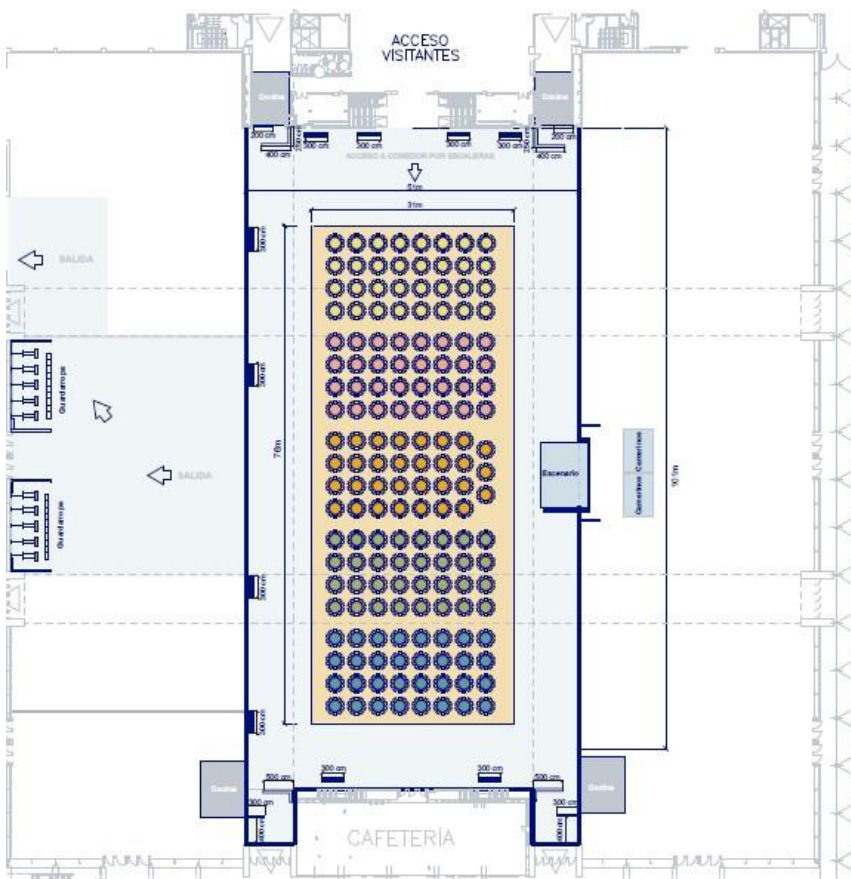

**Formal dinner for 1500 guests in halls 1/3. Catering area in the remaining 2/3**

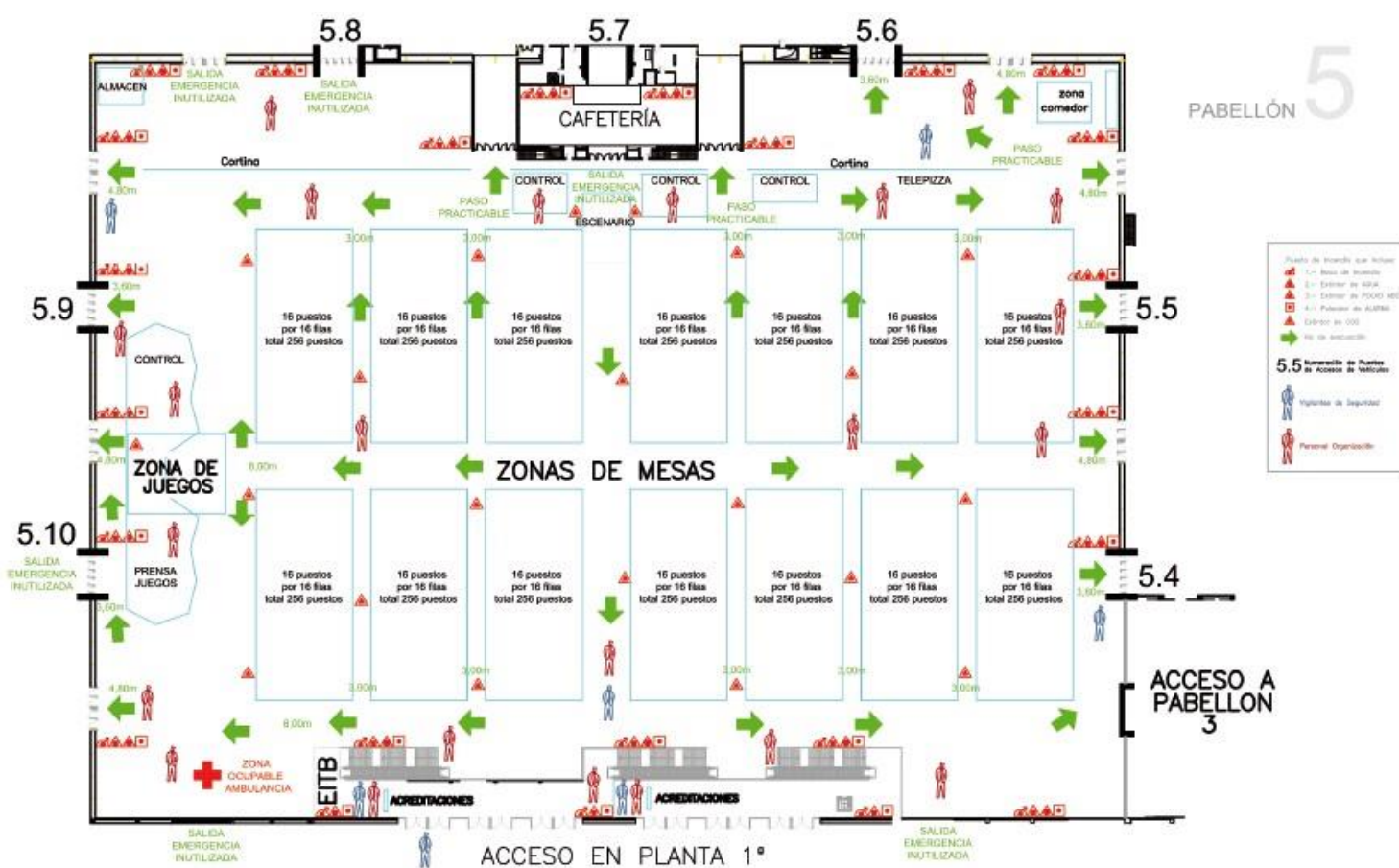

Distribution of Euskal Encounter (Mass meeting of computing amateurs and professionals).