

ROOMS 2 - 8 LEVEL 5

TECHNICAL SPECIFICATIONS

Rooms 2, 3 and 4 are designed as functional rooms with a maximum capacity of 80 people.

Each room can be divided using soundproof panels and can be configured in different ways thanks to their flexibility.

Rooms 5, 6, 7 and 8 have a maximum capacity of 30 people, each of which can be divided into two independent spaces with soundproof panels



ROOM CAPACITIES

NAME OF ROOM	SURFACE AREA (m ²)	HEIGHT (m)	DIMENSION LxW (m)	CAPACITY (People)				
				Theatre	School	"U" TYPE	Cabaret	Board
ROOMS 2, 3 and 4	82	3	12.4 x 6.67	80	40	32	48	30
ROOMS 2A, 2B, 3A, 3B.4A and 4B	41	3	6.2 x 6.67	40	25	12	24	15
ROOMS 5, 6, 7 and 8	43	3	9.20 x 4.76	35	20	16	24	20
ROOMS 5A, 5B, 6A, 6B, 7A, 7B, 8A and 8B	21	3	4.1 x 4.76	15	10	8	-----	12

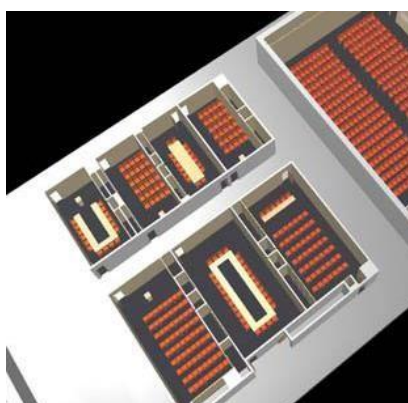
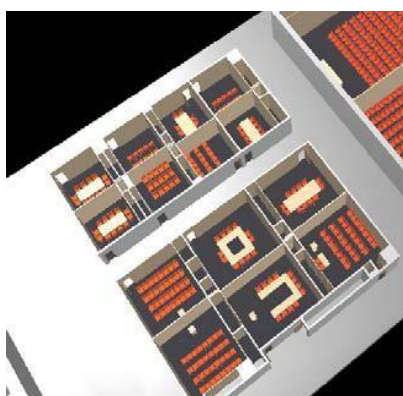

LAYOUT OF ROOMS 2 – 8

The rooms have portable AV system equipment which enables meetings to be monitored, recorded and retransmitted.

NETWORKS + WI-FI

- High capacity Wi-Fi with 5 points distributed between Rooms 2 - 8 with a capacity of 242 users per point.
- Fixed connections across the floor of the Rooms.
- 1000 Mbps broadband that enables up to 800 Mbps to be destined exclusively to an event.

DIFFERENT LAYOUTS FOR ROOMS 2 - 8



Room 3 (Capacity for 80 people)



Room 5 (Maximum capacity for 30 people)



"U" Format Room (Maximum capacity for 24 people)



Exterior perimeter corridor